

PARK

C9a



# THE GROVE

RESIDENCES



#### DETAILS

Bedrooms	2
Bathrooms	2
Carbays	2

#### AREA

Internal	139m <sup>2</sup>
Outdoor living	78m <sup>2</sup>
<b>Total living</b>	<b>217m<sup>2</sup></b>

#### LOCATION

**Residence**  
UG13

#### SCALE

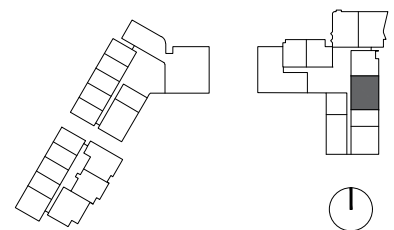

Disclaimer: Variations from Strata Plan may apply. Furniture is indicative. Shape and configuration of terraces, doors, windows, screens and ducts may differ from those illustrated. Areas of Residence given are based on architectural measurements. This varies from strata area as it is a different method of measuring the Residence. Plans not to scale.