



THE GROVE

RESIDENCES

BRIGHTON

A2e

DESIGNER STATEMENT

This large one bedroom apartment has a generous balcony connecting the apartment, across a flush threshold, to leafy Stirling Park and a view, with the site's elevated vantage, to the Cottesloe district. With a large, well-wrought open plan living area, including a large kitchen island, generous bathroom and separate laundry, the apartment has ample access to natural light and views through full height glazing.



DETAILS

Bedrooms	1
Bathrooms	1
Carbays	1

AREA

Internal	68m ²
Outdoor living	16m ²
Total living	84m²

LOCATION

Residence	Similar
132	133
	236
	237

SCALE

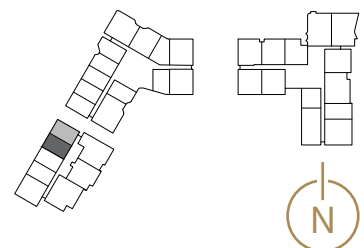

Disclaimer: Variations from Strata Plan may apply. Furniture is indicative. Shape and configuration of terraces, doors, windows, screens and ducts may differ from those illustrated. Areas of Residence given are based on architectural measurements. This varies from strata area as it is a different method of measuring the Residence. Plans not to scale.