

PARK

D2c



THE GROVE

RESIDENCES

DESIGNER STATEMENT

This lavish three bedroom, two bathroom apartment has a wonderful outlook, across a flush threshold and generous balcony, to leafy Stirling Park and a view to the Cottesloe district and the ocean. With a large, well-wrought open plan living area, including a large kitchen island, substantial bathrooms, large separate laundry and a generous master bedroom with ensuite, the apartment has ample access to natural light and views through full height glazing.



DETAILS

Bedrooms	3
Bathrooms	2
Carbays	2

SCALE

0 0.5 1 2.5m

AREA

Internal	139m ²
Outdoor living	39m ²
Carbays	26m ²
Store	5m ²
Total	209m²

LOCATION

Residence
503

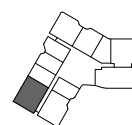

Disclaimer: Variations from Strata Plan may apply. Furniture is indicative. Shape and configuration of terraces, doors, windows, screens and ducts may differ from those illustrated. Areas of Residence given are based on architectural measurements. This varies from strata area as it is a different method of measuring the Residence. Plans not to scale.