

PARK

E7



THE GROVE

RESIDENCES

DETAILS

| | |
|-----------|---|
| Bedrooms | 4 |
| Bathrooms | 2 |
| Car bays | 2 |

AREA

| | |
|---------------------|-------------------------|
| Internal | 209m ² |
| Outdoor living | 56m ² |
| Total living | 265m² |

LOCATION

| | |
|-----------|-----|
| Residence | 504 |
| Similar | 604 |

SCALE

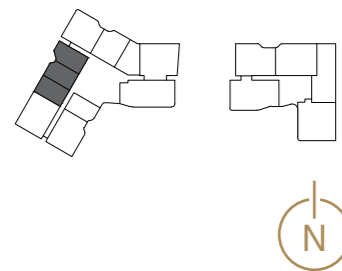
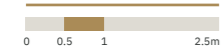

Disclaimer: Variations from Strata Plan may apply. Furniture is indicative. Shape and configuration of terraces, doors, windows, screens and ducts may differ from those illustrated. Areas of Residence given are based on architectural measurements. This varies from strata area as it is a different method of measuring the residence. Plans not to scale.



DESIGNER STATEMENT

This extraordinary three bedroom, two and a half bathroom apartment, has a wonderful outlook, across a flush threshold and generous balcony, to the Cottesloe district and the ocean. With a large, well-wrought open plan living area, including a large kitchen island, scullery, separate tv/ lounge, cellar, substantial bathrooms, large separate laundry and a generous master bedroom with an expansive ensuite, the apartment has ample access to natural light and views through full height glazing.