

BRIGHTON

D19



THE GROVE
RESIDENCES

DESIGNER STATEMENT

This lavish three bedroom, two bathroom apartment has a wonderful outlook, across a flush threshold and generous balcony, to the Cottesloe district and the ocean. With a large, well-wrought open plan living area, including a large kitchen island, study, bar, substantial bathrooms, laundry and a generous master bedroom with an expansive ensuite, the apartment has ample access to natural light and views through full height glazing.



BALCONY CONFIGURATIONS

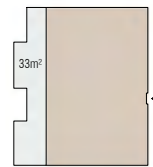

(A) Apt No. 130

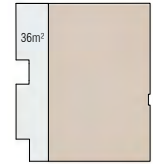

(C) Apt No. 333

DETAILS

Bedrooms	3
Bathrooms	3
Carbays	2

AREA

Internal	137m ²
Outdoor living	33m ²
Total living	170m²

LOCATION

Residence
234

SCALE

