

OCEANSIDE

E18



THE GROVE

RESIDENCES

DETAILS

Bedrooms	4
Bathrooms	3.5
Car bays	2+

AREA

Internal	253m <sup>2</sup>
Outdoor living	78m <sup>2</sup>
<b>Total living</b>	<b>331m<sup>2</sup></b>

LOCATION

Residence	803
Similar	903
	1003
	1103
	1203

SCALE

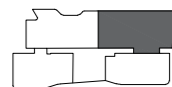
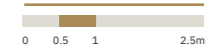

Disclaimer: Variations from Strata Plan may apply. Furniture is indicative. Shape and configuration of terraces, doors, windows, screens and ducts may differ from those illustrated. Areas of Residence given are based on architectural measurements. This varies from strata area as it is a different method of measuring the residence. Plans not to scale.



DESIGNER STATEMENT

This astonishing four bedroom, three and a half bathroom apartment, with a northerly aspect, has a wonderful outlook, across a flush threshold and generous balconies, to the Claremont district to the north and ocean views to the north east. With a large, well-wrought open plan living area, including a large kitchen island, scullery, separate office, substantial bathrooms, large separate laundry and a generous master bedroom with an expansive ensuite, the apartment has ample access to natural light and views through full height glazing.

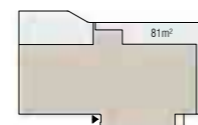

E18a  
Apt no. 703