

BRIGHTON

D19c



THE GROVE  
RESIDENCES

DESIGNER STATEMENT

This lavish three bedroom, two bathroom apartment has a wonderful outlook, across a flush threshold and generous balcony, to the Cottesloe district and the ocean. With a large, well-wrought open plan living area, including a large kitchen island, study, bar, substantial bathrooms, laundry and a generous master bedroom with an expansive ensuite, the apartment has ample access to natural light and views through full height glazing.



DETAILS

Bedrooms	3
Bathrooms	3
Carbays	2

AREA

Internal	137m <sup>2</sup>
Outdoor living	33m <sup>2</sup>
<b>Total living</b>	<b>170m<sup>2</sup></b>

LOCATION

Residence  
333

SCALE

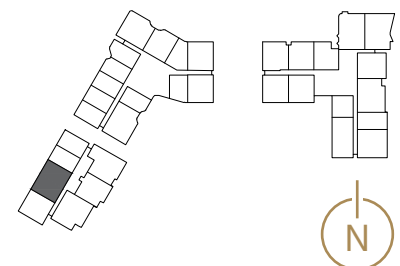
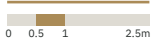

Disclaimer: Variations from Strata Plan may apply. Furniture is indicative. Shape and configuration of terraces, doors, windows, screens and ducts may differ from those illustrated. Areas of Residence given are based on architectural measurements. This varies from strata area as it is a different method of measuring the Residence. Plans not to scale.