

OCEANSIDE

D5



THE GROVE
RESIDENCES

DESIGNER STATEMENT

This lavish three bedroom, two bathroom apartment, with a northern aspect, has a wonderful outlook, across a flush threshold and generous balconies, to the Claremont district to the north and the Cottesloe district and the ocean to the west. With a large, well-wrought open plan living area, including a large kitchen island, scullery, substantial bathrooms, large separate laundry and a generous master bedroom with ensuite, the apartment has ample access to natural light and views through full height glazing.



DETAILS

Bedrooms	3
Bathrooms	2
Carbays	2

AREA

Internal	143m ²
Outdoor living	48m ²
Total living	191m²

LOCATION

Residence	Similar
802	902
	1002
	1102
	1202
	1302

SCALE

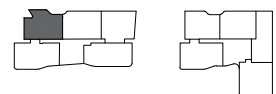
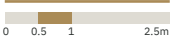

Disclaimer: Variations from Strata Plan may apply. Furniture is indicative. Shape and configuration of terraces, doors, windows, screens and ducts may differ from those illustrated. Areas of Residence given are based on architectural measurements. This varies from strata area as it is a different method of measuring the Residence. Plans not to scale.